

# Public Consultation

## Proposed development at Garages Rear of 31 - 49 Elmfield Way, South Croydon CR2 0EJ

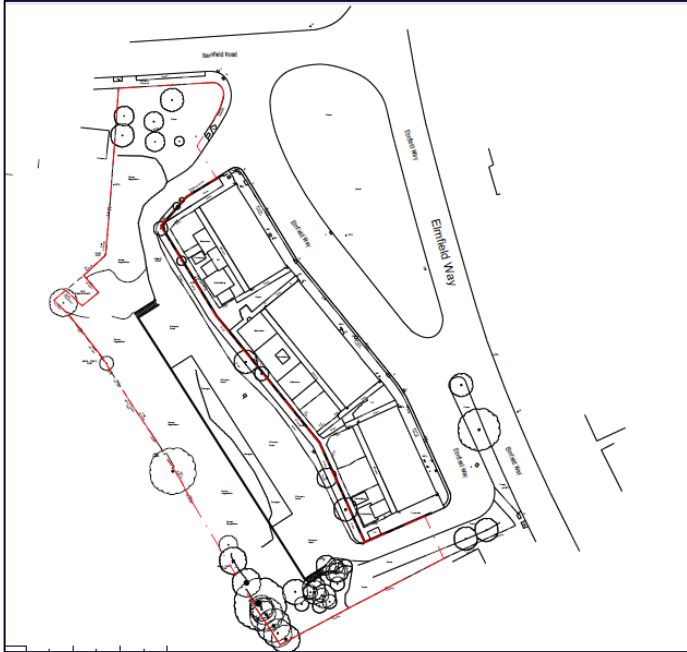

### Site Location & Aerial

#### What is proposed and where?

- The site is located at the garages rear of the shopping parade at Nos. 31-49 Elmfield Way, South Croydon.
- The existing site comprises a series of dilapidated garages that are not fit for purpose, all of which are currently vacant.
- The proposal seeks to develop 8 semi-detached 3-storey houses with access from the unnamed access road via Elmfield Way.
- An additional detached 2-storey house is proposed on the corner of Barnfield Road and Elmfield Way

### Proposed Front Elevation



## Key Elements:

- Seeks to deliver 9 new residential properties, each with 3 bedrooms, 3 bathrooms, off street parking, private gardens, cycle spaces and refuse storage.
- Use of high-quality design and materials to ensure the development integrates with the surrounding properties.
- The houses have been designed to ensure that existing homes would not be overlooked and that the privacy of neighbours is protected.
- The facades are carefully designed to balance solid form with the glazed openings to provide visual interest.

## Proposed Site Plan and Imagery

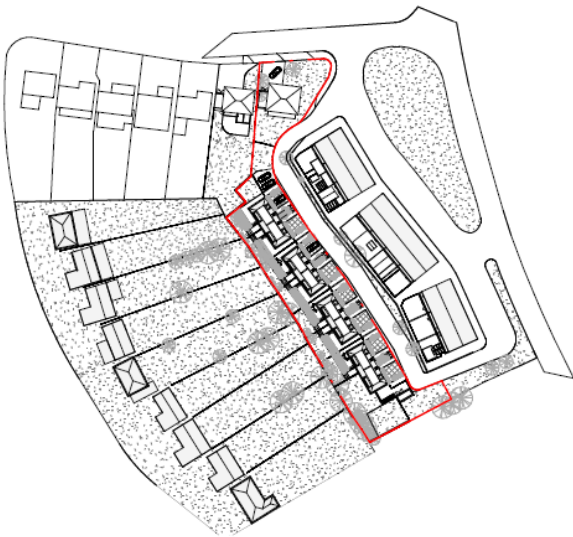

## How do I comment on the proposed development?

We welcome comments on the proposed residential development. Comments can be made to Peacock + Smith by either post or email:

**Post:** Peacock + Smith, Fourth Floor, 8 Baltic Street, London, EC1Y 0UP

**Email:** [Elmfieldway@peacockandsmith.co.uk](mailto:Elmfieldway@peacockandsmith.co.uk)

Any correspondence should be clearly marked with the reference "**Elmfield Way**". In order to ensure that your comments are included within the Community Consultation Report which will be submitted alongside the proposed planning application. Please send us your comments before **Friday 20<sup>th</sup> November 2020.**

## What happens next?

A planning application will be submitted to Croydon Council shortly in order to obtain planning permission for the proposed development. All comments received as part of this consultation will be considered by the applicant and submitted to the Council as part of the planning application.